



*Technology based. Customer driven.*

A stylized white dolphin graphic is positioned in the lower-left quadrant of the page. The dolphin is depicted in profile, swimming towards the right. Its body is composed of several overlapping, curved white lines that create a sense of motion and fluidity. The background is a solid blue color with a subtle gradient, and the overall design is minimalist and modern.

**Dolphin Plus**  
*Instrument Configuration Software*

# About Dolphin Plus

---

*“...dolphins are gregarious, fast, intelligent and friendly.  
They are also superb communicators...”*

Dolphin Plus is the configuration and diagnostic tool used with Milltronics' measurement instruments.

## **Use Dolphin Plus to:**

- manage instrument parameters
  - configure parameters with or without a connected instrument
  - upload and download parameters from an instrument
  - open and save parameter sets from disk
- monitor parameters in real time
- view the measured value as a bar graph
- save and view echo profiles for level instruments

**Use the online help for instructions on these and other tasks.**

## **System Requirements**

Dolphin-compatible Milltronics instrument  
486/66 or better processor (Pentium/120 or better recommended)  
16MB RAM (32MB recommended)  
Windows 95/98 or NT 4.0  
640x480 or higher with 256 colours (800x600 or higher resolution recommended)  
CD-ROM drive for installation  
RS-232 serial connection  
RS-485 converter (if required by instrument)  
Milltronics ComVerter (if required by instrument)

# Installing Dolphin Plus

---

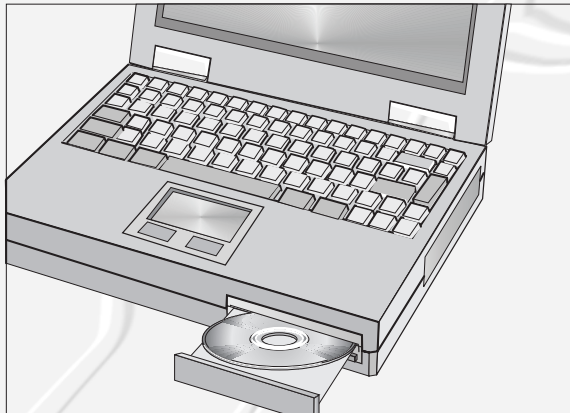

## Software Installation

1. Place the CD-ROM in the reader
2. Click on the **Start** menu
3. Click on **Run**
4. Click on the **Browse...** button
5. Select the CD-ROM drive and **SETUP.EXE** program
6. Follow the instructions on the screen to complete installation

# Serial Cable Connection

## Direct Connect

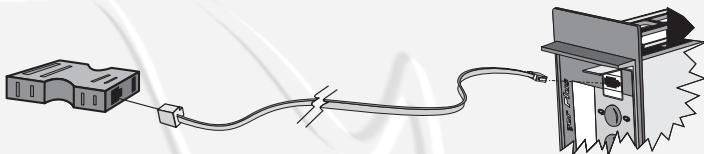

Some instruments (especially rack mount and panel mount models) have a RJ-11 (modular telephone) jack built into the front. To use this connection all you need are:

- RJ-11 – equipped, two-wire, modular telephone cable (included) long enough to reach from the instrument to your computer. The maximum modular cable length is 3.0m (10 ft.).
- 9-pin to RJ-11 adapter (included)

## ComVerter

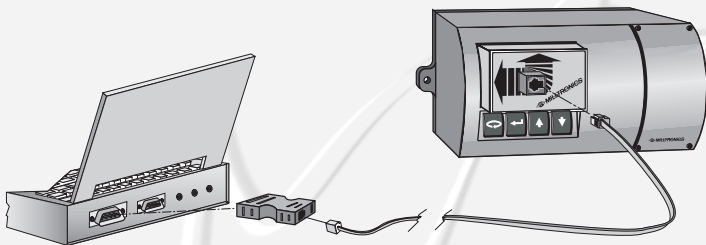

Some instruments (especially wall mount models) have only an infrared programmer connection. To use this connection you need:

- ComVerter (Milltronics' RJ-11 to IR adapter)
- RJ-11 – equipped, two-wire, modular telephone cable (included) long enough to reach from the instrument to your computer
- 9-pin to RJ-11 adapter (included)

# ComVerter Battery Replacement

1

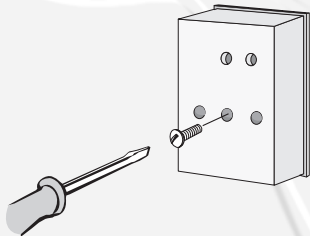

remove screw

2

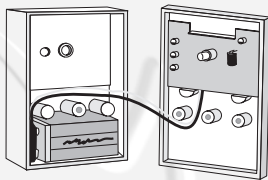

open case

3

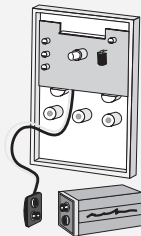

replace battery

**Disconnect ComVerter when not in use to conserve battery life.**

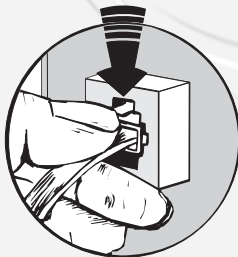

## Terminal Block



An instrument that supports “Dolphin” serial communications also has the option to connect to Dolphin Plus through its terminal block. This allows you to permanently connect your computer to the instrument or to set up a central “communications” area where you can plug into any instrument at the site. To use this connection you need:

- RJ-11 – equipped, two wire cable long enough to reach from the instrument to your computer
- 9-pin to RJ-11 adapter (included)

See your Milltronics instrument manual for instructions on wiring to the terminal block.

## Wiring DB-9 to RJ-11

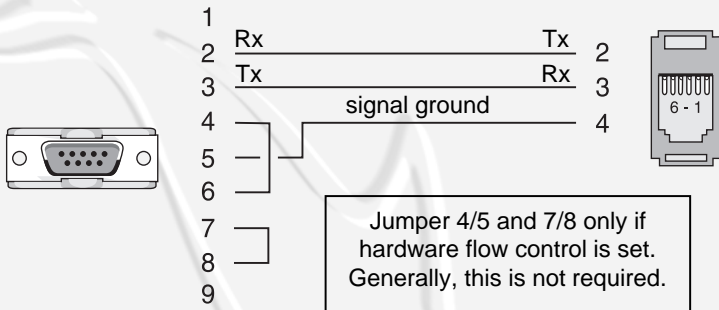

When wiring a DB-9 (9-pin serial) connection from your computer to a RJ-11 (telephone) connection use the wiring scheme above.

- The longest run that a telephone-style cable can support is 3.0m (10 ft.).
- To achieve longer runs use twisted pair shielded cable.

## RS-485 – Non Optically Isolated

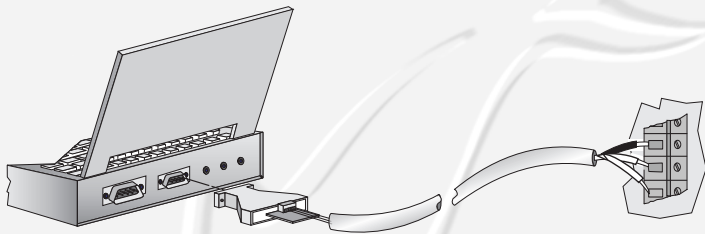

To communicate with some Milltronics instruments you must use the RS-485 protocol. To do this requires an RS-232 to RS-485 adapter (optional).

You can use a non-isolated adapter only on very short cable runs so this option works best with a laptop in the field. The advantage of using a non-isolated adapter is that some models will run directly from the computer's serial port and do not require an external power supply.

See your Milltronics instrument manual for instructions on wiring to the terminal block.

Contact your Milltronics representative to order this part.

## RS-485 – Optically Isolated

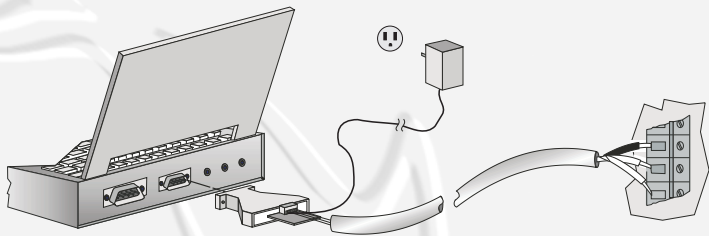

To communicate with some Milltronics instruments you must use the RS-485 protocol. To do this requires an RS-232 to RS-485 adapter (optional).

On longer cable runs, you must use an optically isolated adapter. These adapters require external power supply and so are more difficult to use with battery-powered laptops in the field.

See your Milltronics instrument manual for instructions on wiring to the terminal block.

Contact your Milltronics representative to order this part.

# Specifications

---

## **Dolphin Plus**

- Milltronics software to configure and monitor Milltronics instruments (see front inside cover for system requirements)

## **ComVerter (optional)**

### Power

- 9V battery (style ANSI / NEDA 1604)

### Temperature

- -20 to 50°C (-5 to 122°F)

### Enclosure

- 67mm x 100 mm x 35 mm
- Plastic body
- modular jack, RJ-11 (telephone) style

### Communication

- serial from IBM PC
- optically coupled to Milltronics instrument

### Patents

- South Africa: 93/5198
- Pending: U.S.A., Canada

### Approvals

- CE

## **Cable (included)**

- 3.0m (10 ft.)
- Modular RJ-11 (telephone) plug both ends

## **Adapter (included)**

- RJ-11 (telephone) to DB-9 (PC serial)

## **RS-232 to RS-485**

## **converter (optional)**

- direct connect (powered from PC serial port)
- optically isolated (externally powered)

1954 Technology Dr., P.O. Box 4225, Peterborough, Ontario, **Canada** K9J 7B1  
Tel.: (705) 745-2431 Fax: (705) 741-0466

182 Normanby Rd., Box 339, South Melbourne, **Australia**  
Tel.: +011-613-9695-2400 Fax: +011-613-9695-2450

August van de Wielelei 97, 2100 Deurne, Antwerp, **Belgium**  
Tel.: +32(0)3326 45 54 Fax: +32(0)3326 05 25

Century House, Bridgwater Road, Worcester, **England** WR4 9ZQ  
Tel.: +44 1905-450500 Fax: +44 1905-450501

Parc de la Sainte Victoire, Bât. 5, 13590 Meyreuil, **France**  
Tel.: +33 4 42 65 69 00 Fax: +33 4 42 58 63 95

Werftstrasse 47, D-40549 Dusseldorf, **Germany**  
Tel.: +00 49 211 562 3925 Fax: +00 49 211 562 6030

1 Hoi Wan Street, Suite 602, Quarry Bay, **Hong Kong**  
Tel.: +011 852-2856-3166 Fax: +011 852-2856-2962

Amores No. 1155, Col. Del Valle, 03100 Mexico D.F., **Mexico**  
Tel.: +52 5 575-27-28 Fax: +52 5 575-26-86

Nikkelstraat 10, NL-4823 AB Breda, **The Netherlands**  
Tel.: +31(0)76 542 7 542 Fax: +31(0)76 542 8 542

709 Stadium Drive, Arlington, Texas **U.S.A.** 76011  
Tel.: (817) 277-3543 Fax: (817) 277-3894

A joint venture in **Singapore**, a sales offices in **Brazil**  
and distributors in 56 countries.

Internet : [www.milltronics.com](http://www.milltronics.com)

Printed in Canada